

F 2260 $\varnothing 60$ mm, Graphite Brushes, 80 Watt

NRND See page 13
Not recommended for New Design

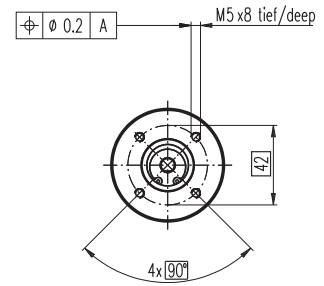
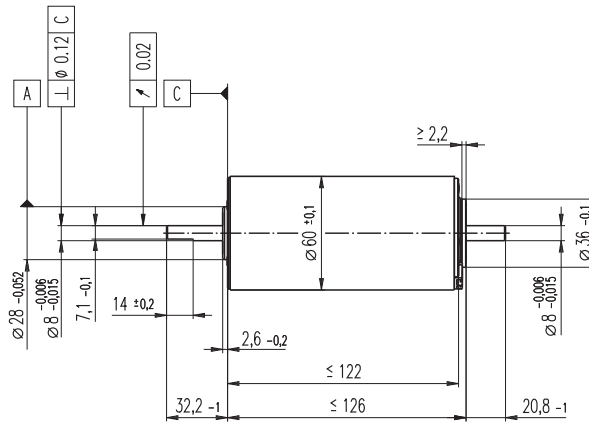
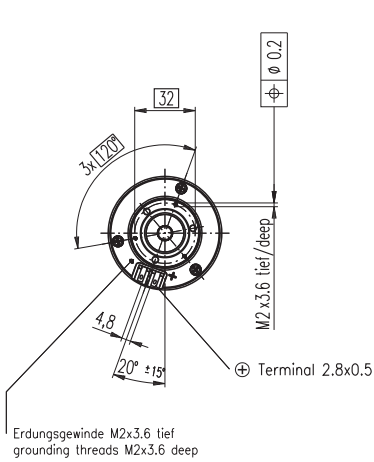

M 1:4

- Stock program
- Standard program
- Special program (on request)

Part Numbers

2260. ... -51.216-200 (Insert winding number)

Winding number 880 881 882 883 884 885 886 887 888 889 890

Motor Data

Values at nominal voltage		880	881	882	883	884	885	886	887	888	889	890
1 Nominal voltage	V	15	18	18	24	24	24	36	42	48	48	48
2 No load speed	rpm	3950	3290	2640	2840	2630	2220	2690	2560	2660	2360	1790
3 No load current	mA	604	398	305	247	226	185	153	124	113	98.2	72
4 Nominal speed	rpm	3570	2900	2230	2440	2220	1810	2290	2160	2270	1950	1380
5 Nominal torque (max. continuous torque)	mNm	190	226	249	253	258	276	273	275	275	280	298
6 Nominal current (max. continuous current)	A	6.10	4.91	4.27	3.48	3.27	2.94	2.33	1.91	1.74	1.56	1.26
7 Stall torque	mNm	2820	2370	1890	2050	1860	1660	2010	1860	1940	1690	1360
8 Starting current	A	82.0	47.3	30.2	26.2	22.0	16.6	16.1	12.2	11.5	8.88	5.42
9 Max. efficiency	%	77.4	78	76.9	78.6	78	77.4	79.8	79.5	80	79	77.4
Characteristics		880	881	882	883	884	885	886	887	888	889	890
10 Terminal resistance	Ω	0.183	0.38	0.596	0.917	1.09	1.44	2.24	3.45	4.17	5.40	8.86
11 Terminal inductance	mH	0.066	0.140	0.218	0.341	0.398	0.559	0.873	1.31	1.59	2.03	3.49
12 Torque constant	mNm/A	34.4	50.0	62.5	78.2	84.4	100	125	153	169	191	250
13 Speed constant	rpm/V	278	191	153	122	113	95.4	76.3	62.3	56.5	50.1	38.2
14 Speed/torque gradient	rpm/mNm	1.48	1.45	1.45	1.43	1.46	1.38	1.37	1.40	1.40	1.42	1.35
15 Mechanical time constant	ms	21.3	20.4	20.1	19.6	19.6	19.3	18.9	18.8	18.8	18.8	18.7
16 Rotor inertia	gcm ²	1380	1340	1320	1310	1280	1340	1320	1280	1280	1260	1320

Specifications

Thermal data	
17 Thermal resistance housing-ambient	3.4 K/W
18 Thermal resistance winding-housing	1.1 K/W
19 Thermal time constant winding	72.5 s
20 Thermal time constant motor	1030 s
21 Ambient temperature	-20...+100°C
22 Max. permissible winding temperature	+125°C

Mechanical data (preloaded ball bearings)	
23 Max. permissible speed	4000 rpm
24 Axial play at axial load < 15 N	0 mm
> 15 N	0.01 - 0.15 mm
25 Radial play ball bearings préchargés	
26 Max. axial load (dynamic)	15 N
27 Max. force for press fits (static) (static, shaft supported)	400 N
28 Max. radial loading, 5 mm from flange	10000 N

Other specifications	
29 Number of pole pairs	2
30 Number of commutator segments	26
31 Weight of motor	1300 g

Values listed in the table are nominal.
Explanation of the figures on page 71.

Operating Range

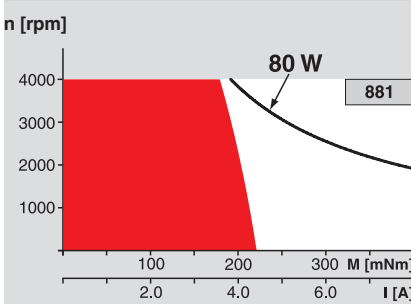

Comments

Continuous operation
In observation of above listed thermal resistance (lines 17 and 18) the maximum permissible winding temperature will be reached during continuous operation at 25°C ambient.
= Thermal limit.

Short term operation
The motor may be briefly overloaded (recurring).

Assigned power rating

maxon Modular System

Overview on page 20 - 25

Planetary Gearhead

$\varnothing 62$ mm
8 - 50 Nm
Page 275

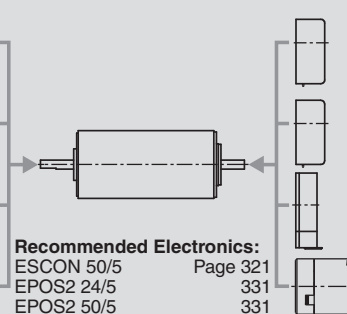
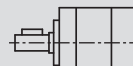

Recommended Electronics:
ESCON 50/5 Page 321
EPOS2 24/5 331
EPOS2 50/5 331
EPOS2 P 24/5 334
Notes 22

Encoder HEDS 5540

500 CPT,
3 channels
Page 306

Encoder HEDL 5540

500 CPT,
3 channels
Page 308

Optional Encoder HEDS 6540

1000 CPT,
3 channels

Brake AB 28

$\varnothing 40$ mm
24 VDC, 0.4 Nm
Page 348